

Е Дисковые пререзные регулируемые фрезы

Тангенциальный тип расположения СМП (Двухсторонние фрезы)

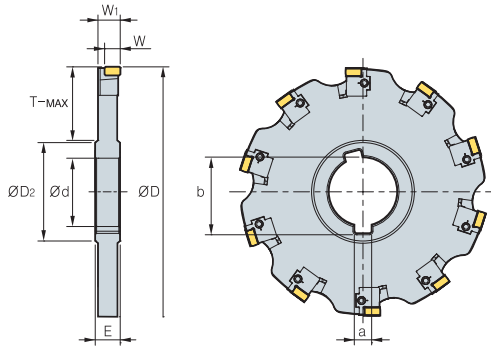

•ТАНСП(М)

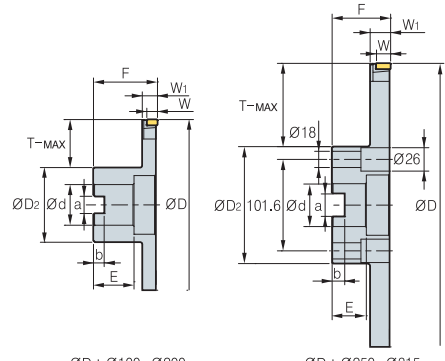

ØD : Ø100~Ø200

ØD : Ø250~Ø315

•ТАНСВ(М)

(мм)

| Обозначение | Ød | E | ØD ₂ | a | b | T-MAX | Обозначение | Ød | F | ØD ₂ | a | b | E | T-MAX | Основные параметры (мм) | | | |
|--|------------|----|-----------------|-----------|------|-----------|--|------------|-------------|-----------------|-------------|----|-----|-------|-------------------------|----|----------------|--------------|
| | | | | | | | | | | | | | | | ØD | W | W ₁ | Число зубьев |
| ТАНСП (М) 10014R/L 12514R/L 16014R/L 20014R/L 25014R/L 31514R/L | 31.75 (32) | 14 | 48 | 7.92 (8) | 35.2 | 24 | ТАНСВ (М) 10014R/L 12514R/L 16014R/L 20014R/L 25014R/L 31514R/L | 31.75 (32) | 50 | 54 | 12.7 (14.4) | 8 | 28 | 21 | 100 | 9 | 13.25 | 6 |
| | 38.1 (40) | 14 | 56 | 9.52 (10) | 42.3 | 32 | | 38.1 (40) | 60 | 70 | 15.9 (16.4) | 10 | 30 | 25 | 125 | 9 | 13.25 | 8 |
| | 38.1 (40) | 14 | 56 | 9.52 (10) | 42.3 | 50 | | 38.1 (40) | 60 | 70 | 15.9 (16.4) | 10 | 30 | 43 | 160 | 9 | 13.25 | 10 |
| | 50.8 (50) | 14 | 72 | 12.7 (12) | 55.8 | 61 | | 50.8 (40) | 65 | 90 | 19.0 (16.4) | 11 | 30 | 53 | 200 | 9 | 13.25 | 12 |
| | 50.8 (50) | 14 | 72 | 12.7 (12) | 55.8 | 86 | | 50.8 (50) | 65 | 130 | 25.4 (25.7) | 14 | 38 | 58 | 250 | 9 | 13.25 | 16 |
| 50.8 (50) | 14 | 72 | 12.7 (12) | 55.8 | 118 | 50.8 (50) | 65 | 130 | 25.4 (25.7) | 14 | 38 | 90 | 315 | 9 | 13.25 | 20 | | |
| ТАНСП (М) 10018R/L 12518R/L 16018R/L 20018R/L 25018R/L 31518R/L | 31.75 (32) | 18 | 48 | 7.92 (8) | 35.2 | 24 | ТАНСВ (М) 10018R/L 12518R/L 16018R/L 20018R/L 25018R/L 31518R/L | 31.75 (32) | 50 | 50 | 12.7 (14.4) | 8 | 28 | 21 | 100 | 12 | 16.75 | 6 |
| | 38.1 (40) | 18 | 56 | 9.52 (10) | 42.3 | 32 | | 38.1 (40) | 60 | 70 | 15.9 (16.4) | 10 | 30 | 25 | 125 | 12 | 16.75 | 8 |
| | 38.1 (40) | 18 | 56 | 9.52 (10) | 42.3 | 50 | | 38.1 (40) | 60 | 70 | 15.9 (16.4) | 10 | 30 | 43 | 160 | 12 | 16.75 | 10 |
| | 50.8 (50) | 18 | 72 | 12.7 (12) | 55.8 | 61 | | 50.8 (40) | 65 | 90 | 19.0 (16.4) | 11 | 30 | 53 | 200 | 12 | 16.75 | 12 |
| | 50.8 (50) | 18 | 72 | 12.7 (12) | 55.8 | 86 | | 50.8 (50) | 65 | 130 | 25.4 (25.7) | 14 | 38 | 58 | 250 | 12 | 16.75 | 16 |
| 50.8 (50) | 18 | 72 | 12.7 (12) | 55.8 | 118 | 50.8 (50) | 65 | 130 | 25.4 (25.7) | 14 | 38 | 90 | 315 | 12 | 16.75 | 20 | | |
| ТАНСП (М) 10021R/L 12521R/L 16021R/L 20021R/L 25021R/L 31521R/L | 31.75 (32) | 21 | 48 | 7.92 (8) | 35.2 | 24 | ТАНСВ (М) 10021R/L 12521R/L 16021R/L 20021R/L 25021R/L 31521R/L | 31.75 (32) | 50 | 54 | 12.7 (14.4) | 8 | 28 | 21 | 100 | 12 | 19.75 | 6 |
| | 38.1 (40) | 21 | 56 | 9.52 (10) | 42.3 | 32 | | 38.1 (40) | 60 | 70 | 15.9 (16.4) | 10 | 30 | 25 | 125 | 12 | 19.75 | 8 |
| | 38.1 (40) | 21 | 56 | 9.52 (10) | 42.3 | 50 | | 38.1 (40) | 60 | 70 | 15.9 (16.4) | 10 | 30 | 43 | 160 | 12 | 19.75 | 10 |
| | 50.8 (50) | 21 | 72 | 12.7 (12) | 55.8 | 61 | | 50.8 (40) | 65 | 90 | 19.0 (16.4) | 11 | 30 | 53 | 200 | 12 | 19.75 | 12 |
| | 50.8 (50) | 21 | 72 | 12.7 (12) | 55.8 | 86 | | 50.8 (50) | 65 | 130 | 25.4 (25.7) | 14 | 38 | 58 | 250 | 12 | 19.75 | 16 |
| 50.8 (50) | 21 | 72 | 12.7 (12) | 55.8 | 118 | 50.8 (50) | 65 | 130 | 25.4 (25.7) | 14 | 38 | 90 | 315 | 12 | 19.75 | 20 | | |
| ТАНСП (М) 12524R/L 16024R/L 20024R/L 25024R/L 31524R/L | 38.1 (40) | 24 | 56 | 9.52 (10) | 42.3 | 32 | ТАНСВ (М) 12524R/L 16024R/L 20024R/L 25024R/L 31524R/L | 38.1 (40) | 60 | 70 | 15.9 (16.4) | 10 | 30 | 25 | 125 | 15 | 22.75 | 8 |
| | 38.1 (40) | 24 | 56 | 9.52 (10) | 42.3 | 50 | | 38.1 (40) | 60 | 70 | 15.9 (16.4) | 10 | 30 | 43 | 160 | 15 | 22.75 | 10 |
| | 50.8 (50) | 24 | 72 | 12.7 (12) | 55.8 | 61 | | 50.8 (40) | 65 | 90 | 19.0 (16.4) | 11 | 30 | 53 | 200 | 15 | 22.75 | 12 |
| | 50.8 (50) | 24 | 72 | 12.7 (12) | 55.8 | 86 | | 50.8 (50) | 65 | 130 | 25.4 (25.7) | 14 | 38 | 58 | 250 | 15 | 22.75 | 16 |
| | 50.8 (50) | 24 | 72 | 12.7 (12) | 55.8 | 118 | | 50.8 (50) | 65 | 130 | 25.4 (25.7) | 14 | 38 | 90 | 315 | 15 | 22.75 | 20 |
| ТАНСП (М) 12527R/L 16027R/L 20027R/L 25027R/L 31527R/L | 38.1 (40) | 27 | 56 | 9.52 (10) | 42.3 | 32 | ТАНСВ (М) 12527R/L 16027R/L 20027R/L 25027R/L 31527R/L | 38.1 (40) | 60 | 70 | 15.9 (16.4) | 10 | 30 | 25 | 125 | 15 | 25.75 | 8 |
| | 38.1 (40) | 27 | 56 | 9.52 (10) | 42.3 | 50 | | 38.1 (40) | 60 | 70 | 15.9 (16.4) | 10 | 30 | 43 | 160 | 15 | 25.75 | 10 |
| | 50.8 (50) | 27 | 72 | 12.7 (12) | 55.8 | 61 | | 50.8 (40) | 65 | 90 | 19.0 (16.4) | 11 | 30 | 53 | 200 | 15 | 25.75 | 12 |
| | 50.8 (50) | 27 | 72 | 12.7 (12) | 55.8 | 86 | | 50.8 (50) | 65 | 130 | 25.4 (25.7) | 14 | 38 | 58 | 250 | 15 | 25.75 | 16 |
| | 50.8 (50) | 27 | 72 | 12.7 (12) | 55.8 | 118 | | 50.8 (50) | 65 | 130 | 25.4 (25.7) | 14 | 38 | 90 | 315 | 15 | 25.75 | 20 |

Применяемые СМП and Рекомендуемые режимы резания E256

• Максимальная ширина фрезы указана для пластин имеющих угол С0,5 или R 0,5

() Метрическая система

Комплектующие

Ширина фрез (ТАНСР/В)



| | | | | | | | | | |
|------------|--------------|-------------|--------|------------|----------|----------|-------|------|-------|
| □□□1418R/L | CNHQ1005-□□□ | LSA-CH10R/L | WSA10N | FTKA0410 | DHA0617 | SHGA0411 | TW15S | HW30 | - |
| □□□1821R/L | CNHQ1305-□□□ | LSA-CH13R/L | WSA13N | FTKA0410 | DHA0821F | SHGA0411 | TW15S | HW40 | HW30L |
| □□□2124R/L | CNHQ1305-□□□ | LSA-CH13R/L | WSA13N | FTKA0410 | DHA0821F | SHGA0411 | TW15S | HW40 | HW30L |
| □□□2427R/L | CNHQ1606-□□□ | LSA-CH16R/L | WSA13N | FTGA0513-P | DHA0821F | SHGA0411 | TW20S | HW40 | HW30L |
| □□□2730R/L | CNHQ1606-□□□ | LSA-CH16R/L | WSA13N | FTGA0513-P | DHA0821F | SHGA0411 | TW20S | HW40 | HW30L |

• Примечание: для фрез 1002124,1001821 ключ клина DHA0818F